



## Installation Manual Double DIN Kit

- **Seat Altea 2005** →
- **Seat Toledo (5P) 2005** →

Colour	Part-No. <i>Standard</i>	Part-No. <i>Rubber-Touch</i>
anthrazit-beige	381328-04	391328-04
black	381328-44	391328-44

Compatible with double DIN devices

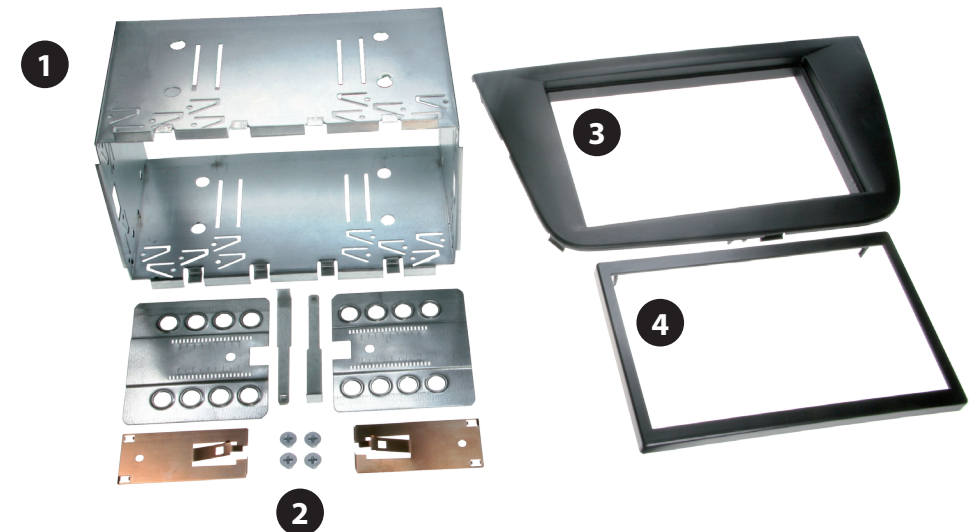

Double DIN Set contents

- (1) Metal Frame
- (2) Installation Kit
- (3) Facia Plate
- (4) Trim Frame



1. Vehicle with OEM head unit.

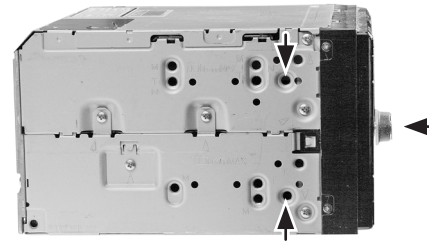

(sample photo)

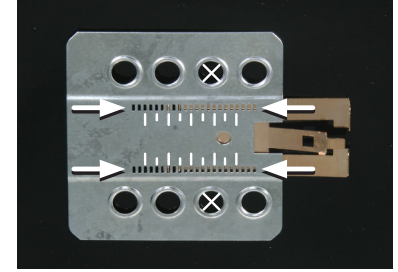

(sample photo)



3. Insert 4 radio release keys into slots on the top and bottom of the radio (see arrows)

Mount the metal brackets to the double DIN head unit.

*The position of the copper coloured holder can be adjusted to your needs for perfect fit. (see sample)*



4. Pull out the OEM head unit.



5. Place the fascia plate on the dashboard.

Push the Metal Frame into the fascia plate.

Connect all required circuit points and push the double DIN head unit in the metal frame until it snaps in.

Place the trim frame.

Reinstall everything in reverse order to finish installation.

*All installation work must be performed by a qualified professional installer only. The manufacturer / dealer is not liable for any kind of incidental or indirect damages.*