

## Installation Manual Double DIN Kit



## Installation Manual Double DIN Kit

standard: 381087-01  
rubber-touch: 391087-01

- Chevrolet Aveo 2006->
- Chevrolet Captiva 2006->
- Chevrolet Epica 2006->

Compatible with these double DIN devices

### Double DIN Navigation

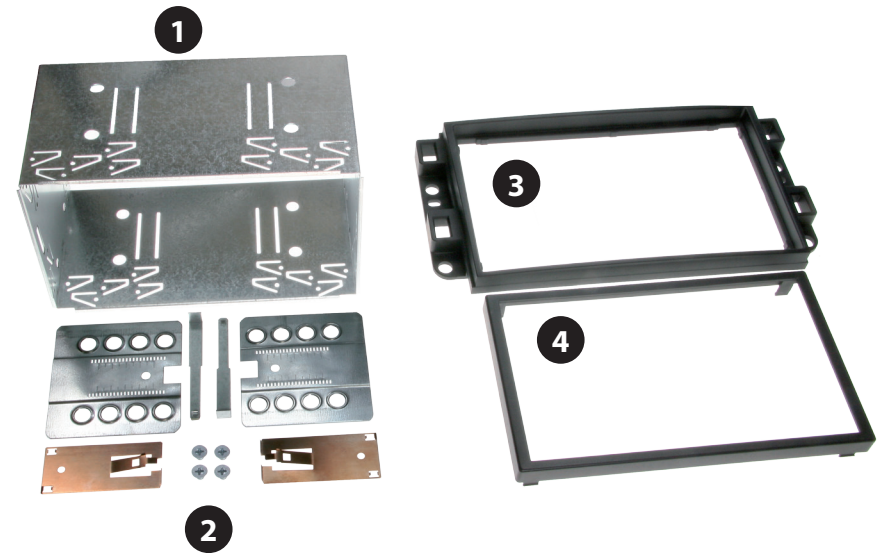

#### Double DIN Set contents

- (1) Metal Frame
- (2) Install Kit
- (3) Mounting Frame
- (4) Trim Frame

## Installation Manual Double DIN Kit



1. Unclip and remove panel ( see arrows )



2. Remove 4 screws ( see arrows )  
Remove OEM head unit



3. Place mounting frame and fix it with 4 screws ( see arrows )

## Installation Manual Double DIN Kit

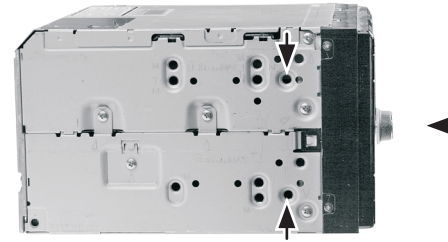

(sample photo)

Mount the metal brackets to double DIN head unit.

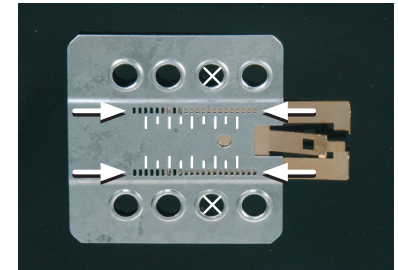

(sample photo)

*The position of the copper coloured holder can be adjusted to your needs for perfect fit. (see sample)*



4. Connect all required circuit points and push the double DIN head unit in the metal frame until it snaps in

Place trim frame